

SOUTH ACADEMY BOULEVARD IMPROVEMENTS PROJECT



May 10, 2024

CONSTRUCTION UPDATE

(All schedules are weather and resource dependent)

Airport Road closes on west side of South Academy Boulevard

South Academy Boulevard between Platte Avenue and Airport Road

Pikes Peak Ave. will fully reopen at South Academy Blvd. on Monday, May 13. Crews continue intersection improvements east of South Academy Blvd. on Pikes Peak Ave. and will reopen all traffic movements through the intersection after this weekend.

Beginning Monday, May 20 a full closure of Airport Rd., west of South Academy Blvd., will be in place through the summer. Both eastbound and westbound Airport Rd. will be fully closed west of South Academy Blvd. to allow crews to complete various underground utility and intersection improvements.

- Airport Rd. motorists are advised to detour north to Pikes Peak Ave. using Chelton Rd. and South Academy Blvd. for east and west access.
- Academy Blvd. motorists detour for west Airport Rd., travel west on Pikes Peak Ave., then south on Chelton Rd. to Airport Rd.

All businesses will remain open and accessible throughout the closure, access from South Academy Blvd. is advised.

Expect delays and use alternative routes. See closure map (below).

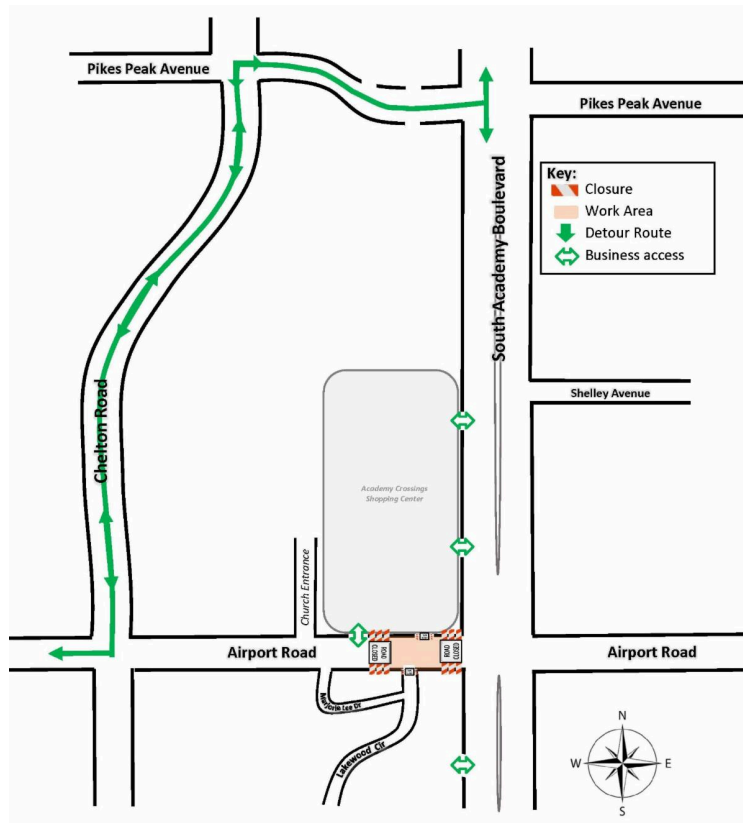

South Academy Boulevard between East Fountain Boulevard and Jet Wing Drive

From Monday, May 20 through Friday, May 24 and again from Tuesday, May 28 through Monday, June 3 Boychuck Avenue will be fully closed in front of the Lamplighter Neighborhood between Hancock Expy. and Drennan Rd. The main entrance to the Lamplighter Neighborhood will be fully closed, neighborhood traffic will use the southern entrance.

- Motorist access to Boychuck Ave. north of the Lamplighter Neighborhood should use Hancock Expy.
- Motorist Access to Boychuck Ave. south of the Lamplighter Neighborhood are encouraged to use Drennan Rd.

These closures will expedite underground waterline installation and new roadway paving along Boychuck Ave. and South Academy Blvd.

Expect delays and use alternative routes. See closure maps, below.

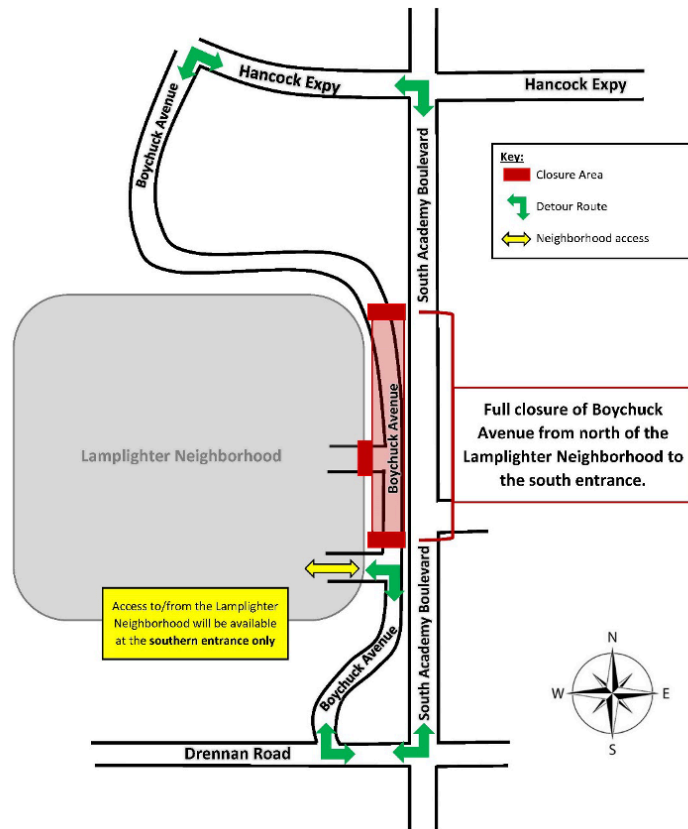

Stay Informed

The South Academy Boulevard Improvements Project addresses aging pavement, curb and gutter, and improves drainage along the project corridor. To provide for better multi-modal and pedestrian access, a new multi-use path is being constructed on one side of Academy Boulevard. Due to existing drainage issues and occasional occurrences of standing water in the roadway, significant drainage improvements are being made.

This is a voter-approved, Pikes Peak Rural Transportation Authority (PPRTA) A-listed project. Estimated cost to address aging pavement, curb and gutter, and improve drainage along the project corridor: \$62 million.

For more information:

Project website: ColoradoSprings.gov/AcademyBlvdImprovements

To receive project updates, email AcademyBlvdImprovements@gmail.com

Project hotline: (719) 427-6422

Visit our Website!

Note: If you wish to no longer receive this specific project newsletter but want to continue receiving other project communications that you previously expressed interest in, please hit "reply" to this email and key in the message "REMOVE." Thank you.



City of Colorado Springs | 30 South Nevada Avenue, COLORADO SPRINGS, CO 80903

[Unsubscribe](#)

[Update Profile](#) | [Constant Contact Data Notice](#)

Sent by monica@bachmanpr.com powered by



Try email marketing for free today!